

- H3F load cells are available in the capacities 0.1t~5t and 250lb~20Klb.
- Alloy steel, sealed by adhesive inside, oil-proof, waterproof and anti-corrosion, suitable for all kinds of environments.
- S beam design, tension and/or compression loading possible, easy installation, suitable for crane scale, mechanical conversion scale, hopper scale and other electronic weighing devices.
- Safe and anti-explosive product, can be used in atrocious environment and hazardous areas.

### Features

- Capacity: 0.1t~5t;250lb~20Klb
- High accuracy
- Alloy steel construction
- Low profile

### Accessory

- HL-3-001 • HL-3-002
- HL-3-003 • HL-3-004 • HL-3-005

### Specifications

Capacity	t	0.1/0.25/0.5/0.75/1/1.5/2/2.5/5					
	lb	250/500/750/1K/1.5K/2K/2.5K/3K/5K/7.5K/10K/15K/20K					
Accuracy		C2	C3	A5S	A5M	B10S	B10M
Maximum number of verification intervals	nmax	2000	3000	5000	5000	10000	10000
Minimum load cell verification interval	vmin	E <sub>max</sub> /5000	E <sub>max</sub> /10000	E <sub>max</sub> /15000	E <sub>max</sub> /15000	E <sub>max</sub> /10000	E <sub>max</sub> /10000
Combined error	(%FS)	≤ ±0.030	≤ ±0.020	≤ ±0.018	≤ ±0.026	≤ ±0.035	≤ ±0.050
Creep	(%FS/30min)	≤ ±0.024	≤ ±0.016	≤ ±0.012	≤ ±0.017	≤ ±0.030	≤ ±0.040
Temperature effect on sensitivity	(%FS/10°C)	≤ ±0.017	≤ ±0.011	≤ ±0.009	≤ ±0.013	≤ ±0.030	≤ ±0.040
Temperature effect on zero	(%FS/10°C)	≤ ±0.023	≤ ±0.015	≤ ±0.010	≤ ±0.014	≤ ±0.030	≤ ±0.020
Output sensitivity	(mv/v)	3.0±0.008					
Input resistance	(Ω)	350±3.5					
Output resistance	(Ω)	351±2.0					
Insulation resistance	(MΩ)	≥5000(50VDC)					
Zero balance	(%FS)	1.0					
Temperature, compensated	(°C)	-10~+40					
Temperature, operating	(°C)	-35~+65					
Excitation, recommended	(V)	5~12(DC)					
Excitation, max	(V)	18(DC)					
Safe overload	(%FS)	150					
Ultimate overload	(%FS)	300					

### Outline Dimension mm (inch)

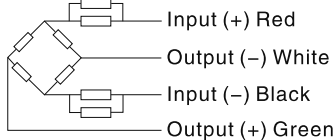
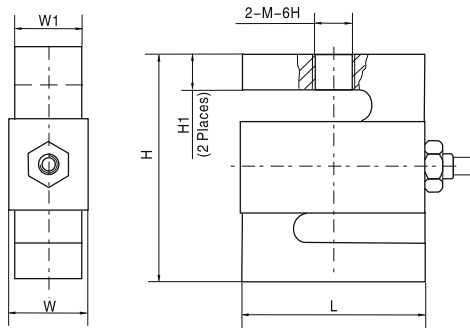

### Wiring:

Adopt shielded, 4 conductor cable: Φ5mm  
Standard cable length: 6m

Capacity	Dimension mm	H	w	w1	L	H1	M
100kg	76.2(3)	20.6(0.81)	19(0.75)	50.8(2)	15.8(0.62)	M10x1.5	
250kg	76.2(3)	20.6(0.81)	19(0.75)	50.8(2)	15.12(0.6)	M12x1.75	
500kg	76.2(3)	20.6(0.81)	19(0.75)	50.8(2)	14.2(0.56)	M12x1.75	
750kg	76.2(3)	20.6(0.81)	19(0.75)	50.8(2)	13.46(0.53)	M12x1.75	
1000kg	76.2(3)	27(1.06)	25.4(1)	50.8(2)	13.24(0.52)	M12x1.75	
1500kg	76.2(3)	27(1.06)	25.4(1)	50.8(2)	11.82(0.47)	M12x1.75	
2000kg	108(4.25)	27(1.06)	25.4(1)	76.2(3)	26.7(1.05)	M18x1.5	
2500kg	108(4.25)	27(1.06)	25.4(1)	76.2(3)	25.48(1)	M18x1.5	
5000kg	108(4.25)	27(1.06)	25.4(1)	76.2(3)	20.26(0.8)	M18x1.5	
250lb	76.2(3)	14.3(0.56)	12.7(0.5)	50.8(2)	15.69(0.62)	3/8-24UNF-2B	
500lb	76.2(3)	20.6(0.81)	19(0.75)	50.8(2)	15.25(0.6)	1/2-20UNF-2B	
750lb	76.2(3)	20.6(0.81)	19(0.75)	50.8(2)	14.95(0.59)	1/2-20UNF-2B	
1K	76.2(3)	20.6(0.81)	19(0.75)	50.8(2)	14.4(0.57)	1/2-20UNF-2B	
1.5K	76.2(3)	20.6(0.81)	19(0.75)	50.8(2)	13.75(0.54)	1/2-20UNF-2B	
2K	76.2(3)	27(1.06)	25.4(1)	50.8(2)	13.4(0.53)	1/2-20UNF-2B	
2.5K	76.2(3)	27(1.06)	25.4(1)	50.8(2)	13.03(0.51)	1/2-20UNF-2B	
3K	76.2(3)	27(1.06)	25.4(1)	50.8(2)	12.39(0.49)	1/2-20UNF-2B	
5K	108(4.25)	27(1.06)	25.4(1)	76.2(3)	27.18(1.07)	3/4-16UNF-2B	
7.5K	108(4.25)	27(1.06)	25.4(1)	76.2(3)	25.78(1.01)	3/4-16UNF-2B	
10K	108(4.25)	27(1.06)	25.4(1)	76.2(3)	23.88(0.94)	3/4-16UNF-2B	
15K	140(5.51)	33.4(1.31)	31.8(1.25)	100(3.94)	31(1.22)	1-14UNS-2B	
20K	177.8(7)	50.9(2)	49.3(1.94)	125.5(4.94)	39.9(1.57)	1-1/4-12UNF-2B	